

# BOCA WEST P.U.D. MASTER PLAT 2

## IN SECTIONS 9, 15, AND 16, TOWNSHIP 47 SOUTH, RANGE 42 EAST

### PALM BEACH COUNTY, FLORIDA

#### IN NINETEEN SHEETS

GEE AND JENSON  
ENGINEERS - ARCHITECTS - PLANNERS, INC.  
FEBRUARY 1989

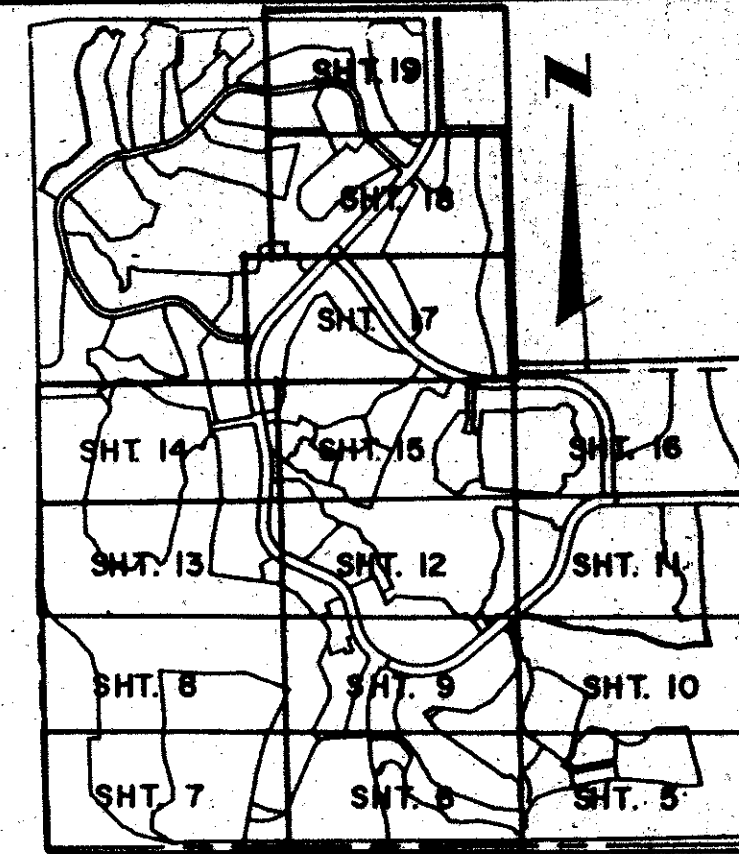

0214026  
**160**

STATE OF FLORIDA  
COUNTY OF PALM BEACH  
This plat was filed for  
record at \_\_\_\_\_ M. this \_\_\_\_ day  
of \_\_\_\_\_ 1990, and duly  
recorded in Plat Book No. \_\_\_\_\_  
on Pages \_\_\_\_\_ and \_\_\_\_\_

JOHN B. DUNKLE  
Clerk Circuit Court

By: \_\_\_\_\_ D.C.

**DESCRIPTION**

**PARCEL 4**

Commencing at the Northeast corner of said Section 9; thence South 01°04'39" East, along the East line of said Section 9, a distance of 1336.85 feet to the Point of Beginning of this description; thence continue South 01°04'38" East, along said East line, a distance of 2691.88 feet to a point on the North line of the Southwest one-quarter of the Southwest one-quarter of said Section 10; thence North 89°34'54" East, along said North line, a distance of 518.07 feet; thence South 00°25'06" East, a distance of 50.00 feet to a point on the Northerly Right-of-Way line of Boca West Drive as shown on the plat of BOCA WEST - BOCA WEST DRIVE - P.U.D., according to the plat thereof, as recorded in Plat Book 34, Pages 135, 136, 137 and 138 of the Public Records of Palm Beach County, Florida; thence South 89°34'54" West, a distance of 627.80 feet to the Point of Curvature of a circular curve to the right; thence Westerly and Northerly, along the arc of said curve, having a radius of 1399.40 feet and a central angle of 02°13'56", an arc distance of 54.52 feet to the Southeast corner of the plat of PEPPER TREE OF BOCA WEST P.U.D., according to the plat thereof, as recorded in Plat Book 35, Pages 119 and 120 of the Public Records of Palm Beach County, Florida; thence North 10°26'55" West, a distance of 314.00 feet; thence North 14°29'36" West, a distance of 221.92 feet; thence North 18°05'40" West, a distance of 226.14 feet; thence North 04°11'15" West, a distance of 167.40 feet; thence North 08°55'13" East, a distance of 98.51 feet; thence North 13°15'53" East, a distance of 410.92 feet to a point on the South line of the Northeast one-quarter of said Section 9; thence continue North 13°15'05" East, a distance of 187.00 feet; thence North 37°30'19" West, a distance of 50.82 feet; thence North 10°39'41" West, a distance of 186.85 feet; thence North 18°54'33" West, a distance of 185.40 feet; thence North 06°30'11" West, a distance of 218.69 feet; thence North 02°39'05" East, a distance of 206.02 feet; thence North 01°33'21" East, a distance of 333.65 feet to a point on the South line of the Northeast one-quarter of the Northeast one-quarter of said Section 9, the last thirteen courses described being coincident with the Easterly line of said plat of PEPPER TREE OF BOCA WEST P.U.D.; thence North 89°51'22" East, along said South line, a distance of 282.34 feet to the point of Beginning of this description.

Containing 17.16 Acres, more or less.

**TOGETHER WITH: PARCEL 5**

Commencing at the Northeast corner of Section 9; thence South 01°04'39" East, along the East line of said Section 9, a distance of 1336.85 feet to a point on the South line of the Northeast one-quarter of the Northeast one-quarter of said Section 9; thence South 89°51'22" West, along said South line, a distance of 596.73 feet to the point of Beginning of this description, said point being further described as being the Northwest corner of the plat of PEPPER TREE OF BOCA WEST P.U.D., according to the plat thereof, as recorded in Plat Book 35, Pages 119 and 120 of the Public Records of Palm Beach County, Florida; thence South 05°42'43" West, a distance of 361.69 feet; thence South 01°44'22" West, a distance of 205.10 feet; thence South 27°58'47" West, a distance of 125.67 feet; thence South 78°18'07" West, a distance of 105.99 feet; thence North 69°12'50" West, a distance of 62.14 feet to the intersection with the arc of a circular curve to the left, whose radius point bears South 48°48'02" West, from the last described point; thence Northerly and Westerly, along the arc of said curve, having a radius of 265.34 feet and a central angle of 06°18'03", an arc distance of 29.18 feet to a point; thence North 30°48'03" West, a distance of 52.20 feet; thence North 03°41'59" West, a distance of 34.61 feet to the intersection with the arc of a circular curve to the left, whose radius point bears North 49°53'58" West, from the last described point, said point being further described as being the Northwest corner of the plat of SABAL LAKE OF BOCA WEST P.U.D., according to the plat thereof, as recorded in Plat Book 43, Pages 159 and 160 of the Public Records of Palm Beach County, Florida; thence North 44°33'36" West, a distance of 1164.00 feet to the Point of Curvature of a circular curve to the right; thence Southerly and Westerly, along the arc of said curve, having a radius of 524.83 feet, an arc distance of 245.49 feet to the Point of Compound Curvature of a circular curve to the right; thence Southerly and Westerly, along the arc of said curve, having a radius of 1527.64 feet, an arc distance of 500.65 feet to the Point of Tangency; thence South 44°33'36" West, a distance of 1060.74 feet, the last four courses described being coincident with the Easterly and Southerly limits of said plat of SABAL LAKE OF BOCA WEST P.U.D., said point being further described as being on the Northerly limits of the plat of BOCA WEST - BOCA WEST DRIVE P.U.D., according to the plat thereof, as recorded in Plat Book 34, Pages 135, 136, 137, and 138 of the Public Records of Palm Beach County, Florida; thence South 44°33'36" West, a distance of 170.00 feet to the Point of Beginning of this description; thence continue South 44°33'36" West, a distance of 875.31 feet to the Point of Curvature of a circular curve to the left; thence Westerly and Southerly, along the arc of said curve, having a radius of 849.99 feet and a central angle of 54°14'00", an arc distance of 804.56 feet to the Point of Tangency; thence South 09°40'24" East, a distance of 295.31 feet to a point on the limits of the plat of OAKBROOK OF BOCA WEST P.U.D., according to the plat thereof, as recorded in Plat Book 32, Pages 92 and 93 of the Public Records of Palm Beach County, Florida; the last three courses described being coincident with the Southeastery Right-of-Way line of said Boca West Drive; thence North 80°19'36" East, a distance of 180.00 feet; thence North 21°26'00" East, a distance of 164.71 feet; thence North 01°05'06" West, a distance of 196.05 feet; thence North 08°56'01" East, a distance of 377.83 feet; thence North 28°55'50" East, a distance of 504.90 feet; thence North 37°45'57" East, a distance of 107.94 feet; thence North 69°19'49" East, a distance of 131.32 feet; thence South 35°39'31" East, a distance of 333.09 feet; thence South 51°00'00" East, a distance of 342.70

Containing 4.73 Acres, more or less.

**TOGETHER WITH: PARCEL 6**

Commencing at the Northeast corner of Said Section 9; thence South 01°04'39" East, along the East line of said Section 9, a distance of 1336.85 feet to a point on the South line of the Northeast one-quarter of the Northeast one-quarter of said Section 9; thence South 89°51'22" West, along said South line, a distance of 596.73 feet to the North West corner of the plat of PEPPER TREE OF BOCA WEST P.U.D., according to the plat thereof, as recorded in Plat Book 35, Pages 119 and 120 of the Public Records of Palm Beach County, Florida; thence South 05°42'43" West, a distance of 361.69 feet; thence South 01°44'22" West, a

**DESCRIPTION CONT.**

distance of 205.10 feet; thence South 27°58'47" West, a distance of 125.67 feet; thence South 78°18'07" West, a distance of 105.99 feet; thence North 69°12'50" West, a distance of 62.14 feet to the intersection with the arc of a circular curve to the left, whose radius point bears South 48°48'02" West, from the last described point; thence Northerly and Westerly, along the arc of said curve, having a radius of 265.34 feet, an arc distance of 29.18 feet to a point; thence North 30°48'03" West, a distance of 52.20 feet; thence North 03°41'59" West, a distance of 34.61 feet to the intersection with the arc of a circular curve to the right, whose radius point bears North 49°53'58" West, from the last described point, said point being further described as being on the Southeastery Right-of-Way line of Boca West Drive, as shown on the plat of SABAL LAKE OF BOCA WEST P.U.D., according to the plat thereof, as recorded in Plat Book 43, Pages 159 and 160 of the Public Records of Palm Beach County, Florida; thence South 44°33'36" West, a distance of 1164.00 feet to the Point of Curvature of a circular curve to the right; thence Southerly and Westerly, along the arc of said curve, having a radius of 524.83 feet, an arc distance of 245.49 feet to the Point of Compound Curvature of a circular curve to the right; thence Southerly and Westerly, along the arc of said curve, having a radius of 1527.64 feet, an arc distance of 500.65 feet to the Point of Tangency; thence South 44°33'36" West, a distance of 1060.74 feet, the last four courses described being coincident with the Easterly and Southerly limits of said plat of SABAL LAKE OF BOCA WEST P.U.D., said point being further described as being on the Northerly limits of the plat of BOCA WEST - BOCA WEST DRIVE P.U.D., according to the plat thereof, as recorded in Plat Book 34, Pages 135, 136, 137, and 138 of the Public Records of Palm Beach County, Florida; thence South 44°33'36" West, a distance of 170.00 feet to the Point of Beginning of this description; thence continue South 44°33'36" West, a distance of 875.31 feet to the Point of Curvature of a circular curve to the left; thence Westerly and Southerly, along the arc of said curve, having a radius of 849.99 feet and a central angle of 54°14'00", an arc distance of 804.56 feet to the Point of Tangency; thence South 09°40'24" East, a distance of 295.31 feet to a point on the limits of the plat of OAKBROOK OF BOCA WEST P.U.D., according to the plat thereof, as recorded in Plat Book 32, Pages 92 and 93 of the Public Records of Palm Beach County, Florida; the last three courses described being coincident with the Southeastery Right-of-Way line of said Boca West Drive; thence North 80°19'36" East, a distance of 180.00 feet; thence North 21°26'00" East, a distance of 164.71 feet; thence North 01°05'06" West, a distance of 196.05 feet; thence North 08°56'01" East, a distance of 377.83 feet; thence North 28°55'50" East, a distance of 504.90 feet; thence North 37°45'57" East, a distance of 107.94 feet; thence North 69°19'49" East, a distance of 131.32 feet; thence South 35°39'31" East, a distance of 333.09 feet; thence South 51°00'00" East, a distance of 342.70

Containing 12.03 Acres, more or less.

**TOGETHER WITH: PARCEL 7**

Commencing at the Northeast corner of said Section 9; thence North 89°59'15" West, along the North line of said Section 9, a distance of 715.86 feet; thence South 01°01'03" East, a distance of 130.03 feet to the Northwest corner of the plat of SABAL LAKE OF BOCA WEST P.U.D., according to the plat thereof, as recorded in Plat Book 43, Pages 159 and 160 of the Public Records of Palm Beach County, Florida; thence North 01°01'03" East, a distance of 1164.00 feet to the Point of Curvature of a circular curve to the right; thence Southerly and Westerly, along the arc of said curve, having a radius of 524.83 feet, an arc distance of 245.49 feet to the Point of Compound Curvature of a circular curve to the right; thence Southerly and Westerly, along the arc of said curve, having a radius of 1527.64 feet, an arc distance of 500.65 feet to the Point of Tangency; thence South 44°33'36" West, a distance of 1060.74 feet, the last four courses described being coincident with the Easterly and Southerly limits of said plat of SABAL LAKE OF BOCA WEST P.U.D., said point being further described as being on the Northerly limits of the plat of BOCA WEST - BOCA WEST DRIVE P.U.D., according to the plat thereof, as recorded in Plat Book 34, Pages 135, 136, 137, and 138 of the Public Records of Palm Beach County, Florida; thence South 44°33'36" West, a distance of 170.00 feet to the Point of Beginning of this description; thence continue South 44°33'36" West, a distance of 875.31 feet to the Point of Curvature of a circular curve to the left; thence Westerly and Southerly, along the arc of said curve, having a radius of 849.99 feet and a central angle of 54°14'00", an arc distance of 804.56 feet to the Point of Tangency; thence South 09°40'24" East, a distance of 295.31 feet to a point on the limits of the plat of OAKBROOK OF BOCA WEST P.U.D., according to the plat thereof, as recorded in Plat Book 32, Pages 92 and 93 of the Public Records of Palm Beach County, Florida; the last three courses described being coincident with the Southeastery Right-of-Way line of said Boca West Drive; thence North 80°19'36" East, a distance of 180.00 feet; thence North 21°26'00" East, a distance of 164.71 feet; thence North 01°05'06" West, a distance of 196.05 feet; thence North 08°56'01" East, a distance of 377.83 feet; thence North 28°55'50" East, a distance of 504.90 feet; thence North 37°45'57" East, a distance of 107.94 feet; thence North 69°19'49" East, a distance of 131.32 feet; thence South 35°39'31" East, a distance of 333.09 feet; thence South 51°00'00" East, a distance of 342.70

**DESCRIPTION CONT.**

feet; thence South 59°01'17" East, a distance of 272.99 feet; thence South 78°26'37" East, a distance of 156.28 feet; thence North 42°55'13" East, a distance of 18.33 feet to the intersection with the arc of a circular curve to the right, whose radius point bears North 42°55'13" East, from the last described point, the last twelve courses described being coincident with the Westerly, Northerly and Northeasterly limits of said plat of OAKBROOK OF BOCA WEST, said point being further described as being on the Southwesterly Right-of-Way line of Boca West Drive as shown on said plat of BOCA WEST - BOCA WEST DRIVE P.U.D.; thence Westerly and Northerly, along the arc of said curve, having a radius of 1519.40 feet and a central angle of 12°31'24", an arc distance of 332.10 feet to the Point of Tangency; thence North 34°33'24" West, a distance of 500.00 feet to the Point of Curvature of a circular curve to the left; thence Northerly and Westerly, along the arc of said curve, having a radius of 1462.12 feet and a central angle of 10°53'00", an arc distance of 277.73 feet to the Point of Tangency; thence North 45°26'24" West, a distance of 145.00 feet; thence South 89°33'36" West, a distance of 35.36 feet to the Point of Beginning, the last five courses described being coincident with Southwesterly Right-of-Way line of Boca West Drive.

Containing 15.58 Acres, more or less.

**TOGETHER WITH: PARCEL 8**

Commencing at the Southeast corner of said Section 9; thence North 01°04'38" West, along the East line of said Section 9, a distance of 25.30 feet to a point on the Southerly limits of the plat of PLANTATION COLONY BOCA WEST P.U.D., according to the plat thereof, as recorded in Plat Book 44, Pages 162 and 163 of the Public Records of Palm Beach County, Florida and the Point of Beginning of this description; thence South 84°27'55" East, a distance of 236.59 feet; thence continue South 84°27'55" East, a distance of 244.72 feet; thence North 41°56'27" East, a distance of 35.53 feet to a point on the Southerly line of said Section 10; thence continue North 41°56'27" East, a distance of 94.04 feet; thence North 00°22'59" East, a distance of 130.01 feet; thence North 89°14'08" East, a distance of 120.72 feet; thence North 42°39'40" East, a distance of 138.13 feet; thence North 00°22'12" West, a distance of 34.97 feet; thence North 23°47'42" West, a distance of 286.11 feet; thence North 20°02'19" East, a distance of 124.05 feet; thence North 47°44'22" West, a distance of 138.29 feet; thence South 81°13'19" West, a distance of 77.28 feet; thence South 45°23'11" West, a distance of 64.23 feet; thence West, a distance of 296.68 feet; thence South 76°03'19" West, a distance of 115.25 feet; thence West, a distance of 90.43 feet to a point on the West line of said Section 10; thence continue West, a distance of 323.74 feet; thence North 05°50'04" West, a distance of 223.42 feet; thence North 70°48'19" West, a distance of 82.00 feet; thence North 25°48'19" West, a distance of 35.36 feet; thence North 19°11'41" East, a distance of 17.45 feet to the Point of Curvature of a circular curve to the left; thence Easterly and Northerly, along the arc of said curve, having a radius of 389.81 feet and a central angle of 21°45'28", an arc distance of 148.03 feet to the Point of Tangency; thence North 02°33'47" West, a distance of 110.81 feet; thence North 87°26'13" East, a distance of 4.00 feet to the intersection with the Point of Curvature of a circular curve to the right, whose radius point bears North 87°26'13" East, from the last described point, the last twelve courses described being coincident with the Easterly and Southerly limits of said plat of PLANTATION COLONY BOCA WEST P.U.D., said point being further described as being on the arc of a circular curve to the left, whose radius point bears North 09°08'40" East, from the last described point; thence Southerly and Easterly, along the arc of said curve, having a radius of 1519.40 feet and a central angle of 09°33'46", an arc distance of 253.58 feet to the Point of Tangency; thence North 89°34'54" East, a distance of 627.80 feet to the Point of Curvature of a circular curve to the right; thence Easterly and Southerly, along the arc of said curve, having a radius of 490.00 feet and a central angle of 90°00'00", an arc distance of 769.69 feet to the Point of Tangency; thence South 00°25'06" East, a distance of 705.90 feet; thence South 40°02'53" West, a distance of 32.45 feet to the intersection with the arc of a circular curve to the left, whose radius point bears South 09°29'08" East, from the last described point; thence Westerly and Southerly, along the arc of said curve, having a radius of 596.05 feet and a central angle of 65°10'48", an arc distance of 596.05 feet to the Point of Tangency; thence South 15°20'03" West, a distance of 29.03 feet, the last seven courses described being coincident with the Westerly and Northwesterly limits of the Right-of-Way line of Boca West Drive as shown on said plat of BOCA WEST - BOCA WEST DRIVE P.U.D., thence North 43°45'26" West, a distance of 52.97 feet; thence South 45°02'17" West, a distance of 19.83 feet; thence North 77°12'20" West, a distance of 41.78 feet; thence North 22°55'39" West, a distance of 99.16 feet; thence North 81°29'11" West, a distance of 66.52 feet; thence North 67°32'31" West, a distance of 66.52 feet; thence North 80°21'00" West, a distance of 103.83 feet; thence North 65°12'12" West, a distance of 78.51 feet; thence North 72°28'04" West, a distance of 134.98 feet; thence North 76°48'37" West, a distance of 91.01 feet; thence North 83°21'40" West, a distance of 119.95 feet; thence South 31°38'25" West, a distance of 50.25 feet; thence South 01°29'54" East, a distance of 135.85 feet; thence South 19°02'39" East, a distance of 127.2 feet; thence South 2°56'19" East, a distance of 59.94 feet; thence South 03°54'00" East, a distance of 43.86 feet; thence South 08°50'84" East, a distance of 67.38 feet; thence South 14°32'55" West, a

**DESCRIPTION CONT.**

distance of 66.52 feet; thence South 10°58'59" West, a distance of 77.88 feet; thence South 20°20'28" West, a distance of 89.24 feet; thence South 37°09'01" West, a distance of 45.13 feet; thence South 02°29'16" West, a distance of 107.84 feet; thence South 13°27'00" West, a distance of 75.58 feet; thence South 23°47'57" West, a distance of 112.23 feet; thence South 66°22'26" West, a distance of 30.38 feet; thence South 24°50'16" West, a distance of 161.78 feet; thence South 49°49'13" West, a distance of 144.19 feet; thence North 40°10'47" West, a distance of 88.75 feet; thence South 72°58'52" West, a distance of 95.00 feet; thence North 00°10'47" West, a distance of 251.00 feet; thence North 87°05'00" West, a distance of 353.52 feet; thence North 87°42' West, a distance of 182.67 feet; thence North 49°25'29" East, a distance of 28.63 feet; thence North 28°52'13" West, a distance of 94.90 feet, to a point, said point being the Southeastery most corner of THE COVE AT BOCA WEST, a plat recorded in Plat Book 56, Pages 143 and 144, of the Public Records of Palm Beach County, Florida; thence continue North 28°52'13" West, a distance of 28.48 feet; thence North 28°13'39" West, a distance of 191.66 feet; thence North 43°44'17" West, a distance of 25.81 feet; thence North 28°13'39" West, a distance of 72.19 feet; thence North 05°16'14" West, a distance of 59.62 feet; thence North 22°28'01" West, a distance of 128.93 feet; thence North 61°09'38" West, a distance of 121.91 feet; thence North 25°03'07" West, a distance of 155.33 feet; thence North 68°32'26" West, a distance of 177.86 feet; thence South 72°55'56" West, a distance of 30.28 feet, the last twelve courses described being coincident with the boundary of said Cove at Boca West; thence North 45°17'35" West, a distance of 52.04 feet; thence North 5°50'44" West, a distance of 90.60 feet; thence North 79°54'59" West, a distance of 55.90 feet; thence North 41°38'42" West, a distance of 45.34 feet; thence North 15°22'19" West, a distance of 149.28 feet; thence South 89°46'43" West, a distance of 55.00 feet; thence North 22°32'13" West, a distance of 146.11 feet; thence North 51°27'10" West, a distance of 146.53 feet to a point on the Southerly line of an 80.00 foot Lake North Drainage District easement or Canal L-44, as recorded in Official Records Book 2511, Page 1260, of the Public Records of Palm Beach County, Florida; thence South 89°46'43" West, along the Southerly Right-of-Way line, a distance of 310.39 feet to a point on the Easterly Right-of-Way line of Boca West Drive as shown on said plat of LAKEWOOD OF BOCA WEST P.U.D., the last nine courses described being coincident with the Easterly and Northerly limits of the said BOCA WEST MAINTENANCE FACILITY; thence North 04°44'21" East, a distance of 36.04 feet to the Point of Curvature of a circular curve to the left; thence Northerly, along the arc of said curve, having a radius of 1246.33 feet and a central angle of 13°26'07", an arc distance of 292.28 feet to a point on the Southerly line of PLAT NO. 1 HAMLET "C" OF BOCA WEST, according to the plat thereof, as recorded in Plat Book 35, Pages 127 and 128 of the Public Records of Palm Beach County, Florida, the last two courses described being coincident with the Easterly Right-of-Way line of Boca West Drive of said plat of LAKEWOOD OF BOCA WEST P.U.D.; thence South 56°44'32" East, a distance of 145.16 feet; thence South 50°46'00" East, a distance of 67.00 feet; thence continue South 50°46'00" East, a distance of 58.00 feet; thence South 50°46'00" East, a distance of 113.75 feet; thence South 89°55'35" East, a distance of 23.48 feet; thence North 58°17'21" East, a distance of 15.69 feet; thence South 86°13'17" East, a distance of 28.43 feet; thence South 63°32'48" East, a distance of 29.01 feet; thence South 88°13'08" East, a distance of 61.37 feet; thence South 52°53'57" East, a distance of 48.66 feet; thence South 60°04'15" East, a distance of 25.02 feet; thence South 68°06'20" East, a distance of 52.54 feet; thence South 64°52'54" East, a distance of 23.11 feet; thence South 74°14'51" East, a distance of 51.13 feet; thence South 73°44'52" East, a distance of 7.46 feet to a point on the Southerly line of Fairway Point as recorded in Plat Book 55, Pages 4 and 5, Palm Beach County Records, the last thirteen courses described being coincident with the Southerly limits of said PLAT NO. 2 HAMLET "C" OF BOCA WEST P.U.D.; thence South 74°55'38" East, a distance of 73.69 feet; thence South 83°21'33" East, a distance of 28.62 feet; thence South 65°26'51" East, a distance of 57.96 feet; thence South 17°53'26" East, a distance of 52.92 feet; thence South 22°52'26" East, a distance of 36.62 feet; thence South 09°05'13" East, a distance of 39.40 feet; thence South 89°45'22" East, a distance of 90.06 feet; thence South 73°58'36" East, a distance of 156.52 feet; thence North 89°51'22" East, a distance of 20.72 feet; thence North 19°16'51" East, a distance of 165.10 feet to a point on the South line of said Section 9; thence continue North 19°16'51" East, a distance of 307.37 feet; thence North 29°34'26" East, a distance of 100.50 feet; thence North 24°40'50" East, a distance of 124.53 feet to a point on the Southerly line of the plat of FAIRWAY OAKS AT BOCA WEST, according to the plat thereof, as recorded in Plat Book 40, Pages 141 and 142 of the Public Records of Palm Beach County, Florida; the last thirteen courses described being coincident with the Southerly and Easterly limits of said Fairway Point; thence North 24°40'50" East, a distance of 223.71 feet; thence North 27°36'31" East, a distance of 48.76 feet; thence North 21°20'26" East, a distance of 72.32 feet; thence North 30°05'33" East, a distance of 61.29 feet; thence North 75°04'38" East, a distance of 76.19 feet; thence South 42°12'22" East, a distance of 195.80 feet; thence North 31°52'12" East, a distance of 41.44 feet to a point; thence North 71°39'12" East, a distance of 81.44 feet to a point on the Southerly Right-of-Way line of Boca West Drive as shown on said plat of BOCA WEST - BOCA WEST DRIVE P.U.D., said point being further described as being the intersection with the arc of a circular curve to the left, whose radius point bears North 18°24'52" East, the last eight courses described being coincident with the Easterly and Southerly limits of said plat of FAIRWAY OAKS OF BOCA WEST; thence Southerly and Easterly, along the arc of said curve, having a radius of 1519.40 feet and a

TAZ 607

SUBMISSION # BOCA WEST MASTER PLAT 2  
PAGE NO. 160  
FLOOD MAP # 230B  
ZONING A R  
REV. 85-7  
DATE 01/14/89

COMPUTED DW. LEI/CADD  
DRAWN D.L.B.  
CHECKED J.H.D.  
APPROVED J.H.D.  
REVISION

**BOCA WEST MASTER PLAT 2 66/160**